

Aufschrift  
marking

1006 T100  
10(4)/400 ~ 10E3  
6(2.5)/400 ~ 50E3

10A 125V AC 1/4HP  
10A 250V AC 1/4HP  
R44

Herstellort / -jahr / -woche  
date code of manufacture:  
place / year / week

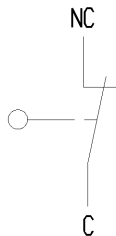
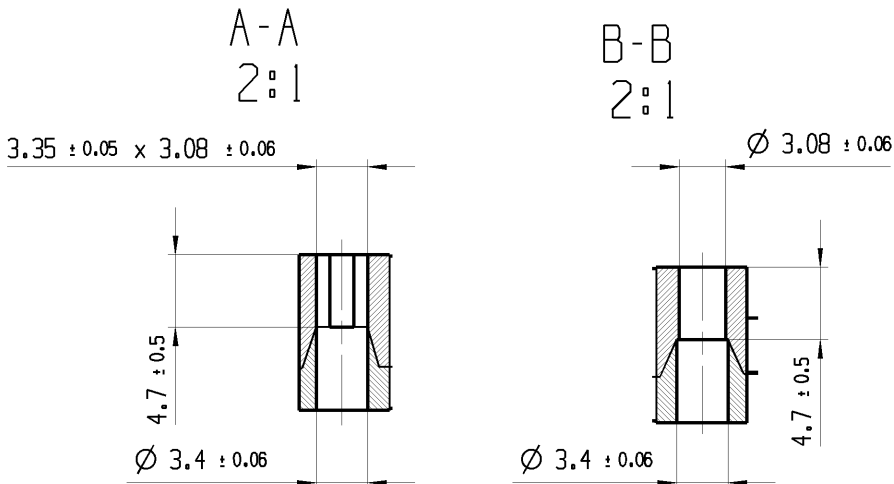

Öffner 1-polig  
SPNC  
Schalt-Betaetigungskraft 1.6 bis 2.8 N  
actuating force 1.6 up to 2.8 N  
Differenzweg ≤ 1 mm  
movement differential

fuer Form und Lage FOR SHAPE AND LOC.	⊙ =	Allgemeintoleranzen UNTOLERANCED DIMENSIONS				Pause COPY	Blatt SHEET 01	TYP K	Zeichn./DRAWING NO. 10063402	Index c
	fuer Winkel FOR ANGLE ± 2	PROJEKTION	Abmasse und Nennmassbereiche Angaben in mm	Laenge LENGTH	Radial RADII					
ALL DIMENSIONS ARE IN MILLIMETRES			0-6 ± 0.1	± 0.2	0 10 20 30mm	SCHNAPPSCHALTER				
			>6-15 ± 0.15	± 0.3		snap action switch				
			>15-30 ± 0.2	± 0.5		CAD: NX v8.5 gez./DRAWN BY 11/12/13 BRC gepr./CHECKED BY Ersatz fuer/REPLACEMENT OF Zg.gl.Nr.v.13.10.1999				
			>30-70 ± 0.3	± 10%						
			>70-120 ± 0.4		MARQUARDT					
			>120 ± 0.8							
Ausg. ISSUE	Aenderung REVISION	gez. DRAWN BY	Ausg. ISSUE	Aenderung REVISION	gez. DRAWN BY					