

6

5

4

3

2

1

APPROVED: \_\_\_\_\_

DATE: \_\_\_\_\_ TITLE: \_\_\_\_\_

Rev	AWO #	Description	Date	Appr
-----	-------	-------------	------	------

SEE SHT 1 OF 2 FOR REVISION

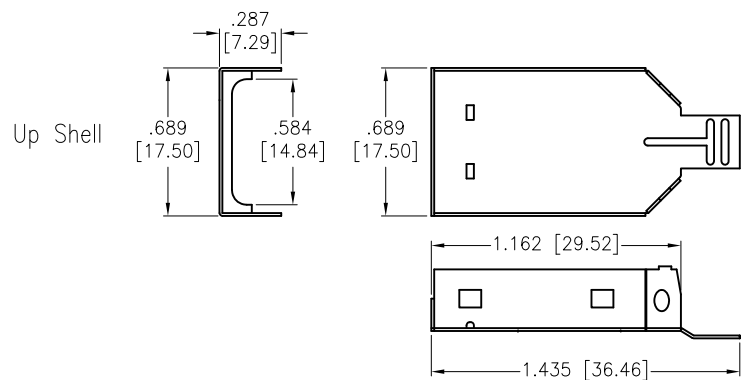

USB-C31-PLUG-C-BK-PCB-A

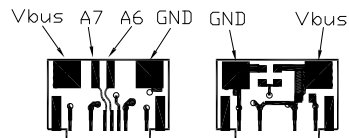

C-2.0

USB-C31-PLUG-C-BK-PCB-B

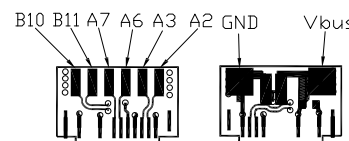

C-3.0

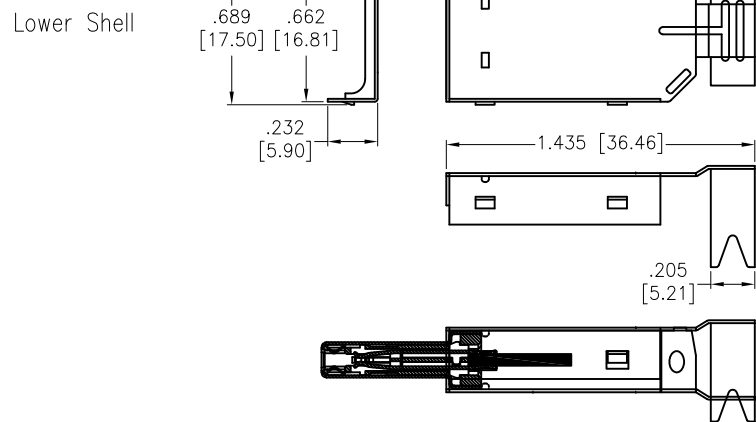

USB-C31-PLUG-C-BK-PCB-C

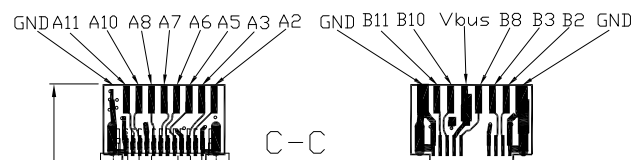

C-C

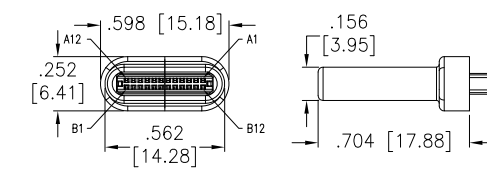
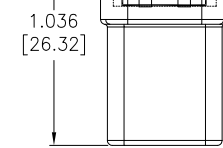

SPECIFICATIONS:

Material:

Upper Shell: Steel, Nickel plated

Lower Shell: Steel, Nickel plated

Electrical:

Current rating: 0.5 A

Contact resistance: 30 mohms max

Insulation resistance: 100 Mohms min @ 250 VDC

Dielectric withstanding: 250 VAC for 1 minute

Mechanical:

Insertion force: 3.57kgf max.

Withdrawal force: 1.02kgf min.

Environmental:

Lead free, RoHS compliant.



UNLESS OTHERWISE SPECIFIED  
ALL DIMENSIONS ARE INCHES [MM]  
TOLERANCES: EXCEPT AS NOTED

INCHES		HOLES	
.X	± .10	∅X	± .10
.XX	± .020	∅.XX	± .015
.XXX	± .015	∅.XXX	± .010

# ADAM TECH

909 Rahway Avenue, Union, NJ 07083  
Phone: 908-687-5000 Fax: 908-687-5710

TITLE UNIVERSAL SERIAL BUS, TYPE C, MALE PLUG,  
STRADDLE MOUNT, BLACK INSULATOR

APPROVALS		DATE
DRAWN	HR	10/1/15
CHECKED	AC	10/1/15
APPROVED		

SIZE X	PART NO. USB-C31-PLUG-C-BK-PCB-X	REV. A
REF: S00097C	SCALE: NTS	SHEET 2 OF 2

6

5

4

3

2

1